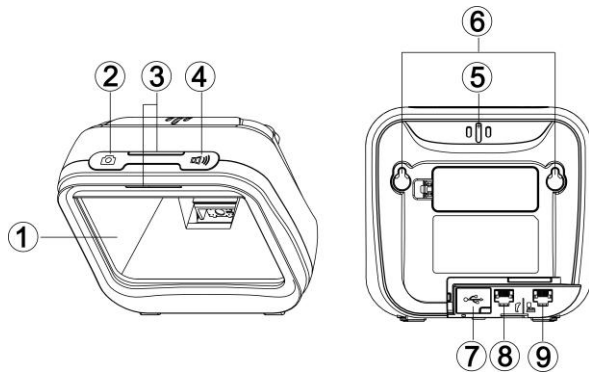

Image Platform Quick Guide

Notice

- A standard packing includes an image platform, a 5V adaptor, a USB cable and a quick guide.
- Accessories include a stand, a RS232 cable and a PS2 cable.
- Use a piece of dry and soft cloth when cleaning the image platform is in need.

Parts of the scanner



- ① Exit window
- ② Camera push button
- ③ LED
- ④ Beeper push button
- ⑤ Beeper
- ⑥ Hanging holes
- ⑦ USB interface
- ⑧ Auxiliary interface for handheld scanner, etc.
- ⑨ Host interface

Installing the cable

1. Refer to the below pictures, connect the host with the platform based on different cables;
2. Ensure that all connections are secure.
3. If the installation is successful, the beeper will beep and LED will light.

Note: If you use the PS/2 keyboard cable, you must restart the device after the connection is successful.



USB cable

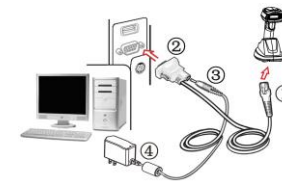

RS232 cable

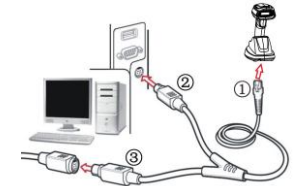

PS/2 keyboard cable

Reading techniques

1. Move the barcode to close to the image platform.
2. In general, the reading range of the image platform is limited to 2-8cm regardless of the size of the minimal element of the barcode.
3. On a successful reading, the beeper will beep and the LED will light. If no barcode closes to the image platform in a moment, the image platform will go to sleep.

Programming instruction and example

Two programming modes have been provided as bellows:

➤ Single-scan setting

Scan the appropriate single-scan setting barcode.

Scan the appropriate

Single-scan setting



%0301D03%

Example: To set Flow control to be XON/XOFF.

➤ Multiple-scan setting

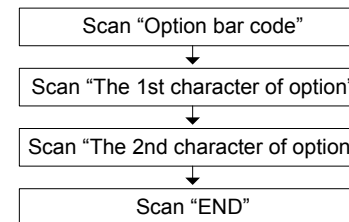

%0301M%



0



3



%END%

Example: To set Flow control to be XON/XOFF.

Field of view

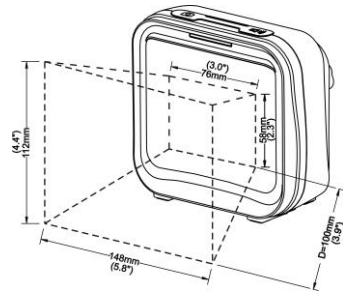

Figure 1-1 Field of view

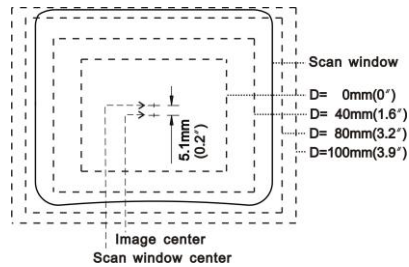

Figure 1-2 Field of view – Front view

Assembling the stand



Figure 2-1

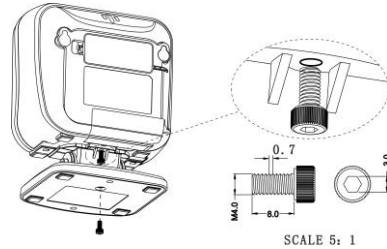

Figure 2-2



Figure 2-3

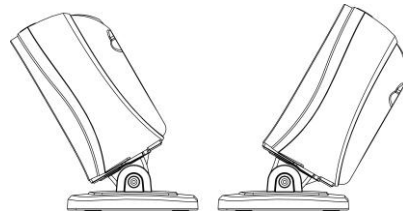

Figure 2-4

1. As shown in Figure 2-1, plug in two connection-arms to the two associated notches on the bottom of the image platform.
2. As shown in Figure 2-2, well connect the image platform with the stand by tightening the single screw.
3. As shown in Figure 2-3, if you want to fix the stand on a table or other platform, you can remove two plastic stopper on the stand (see ①), then fix the stand with a table with appropriate screws.
4. As shown in Figure 2-4, adjust the image platform forward/backward for a desired position.

Initialization settings and information display

Default value initialization



%%%DEF

Firmware version list



%%%VER

Beeper indication

Disable



%0503D00%

Enable*



%0503D01%

Volume of beeper

Low



%0505D00%

Middle



%0505D01%

High*



%0505D02%

Note: The factory default settings are indicated with asterisks ().*